

PART NO. P2-1096

| ITEM NO. | NO. REQ'D | PART NO. | DESCRIPTION | MATERIAL |
|----------|-----------|----------|-------------------------|------------------|
| 1 | 1 | 654127 | 2 HOLE SPADE | COPPER, C83300 |
| 2 | 1 | 553001 | GASKET | NITRILE (BUNA-N) |
| 3 | 1 | 231890 | BUSHING | PORCELAIN |
| 4 | 1 | 604415 | STUD | COPPER, C11000 |
| 5 | 2 | 506362 | CLAMP SET | SILICON BRONZE |
| 6 | 1 | 553144 | GASKET | NITRILE (BUNA-N) |
| 7 | 1 | 580392 | SPECIAL WASHER | BRASS |
| 8 | 1 | 585040 | SINGLE COIL LOCK WASHER | SILICON BRONZE |
| 9 | 3 | 570400 | HEX NUT | BRASS |

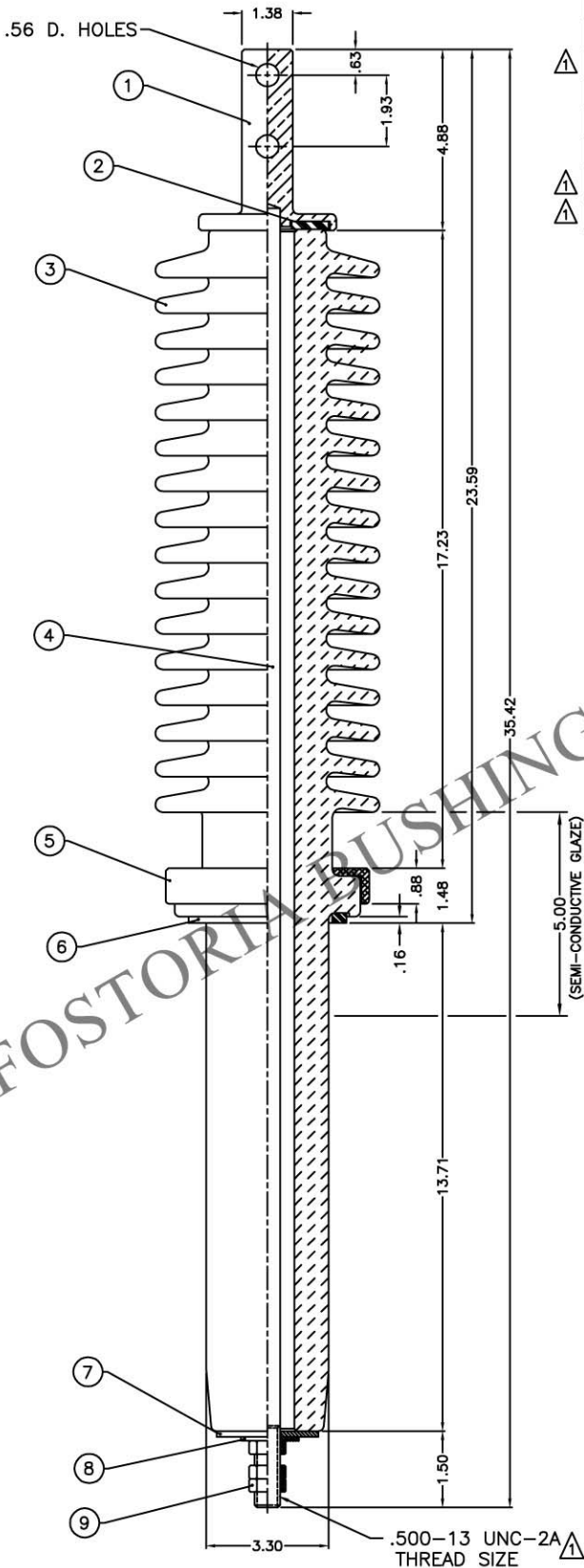

.44 D. HOLES ON 5.50 D. B.C.

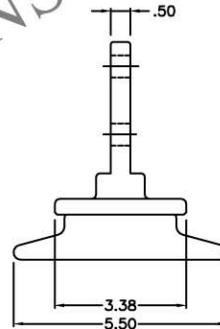
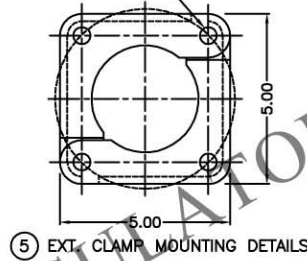

RATINGS: (OIL TO AIR APPLICATION)

34.5 kV. CLASS

200 kV. B.I.L.

125 AMPERES

NOTES:

1. THE COPPER STUD AND TIN PLATED SPADE ARE JOINED BY SOLDERING.
2. PORCELAIN COLOR - GRAY
SEMI-CONDUCTIVE GLAZE - DARK BROWN
3. LEAKAGE DISTANCE - 47" (MIN.)
4. ALL DIMENSIONS IN INCHES.
5. ELECTRODAG 213 IN GASKET SEAT.
6. RATINGS GIVEN ARE BASED ON USE IN A LIQUID FILLED TRANSFORMER WITH LOWER END OF BUSHING UNDER OIL LEVEL. FOR MAXIMUM PERFORMANCE OF BUSHING, THE GAP BETWEEN THE PORCELAIN AND THE STUD MUST BE FLOODED WITH OIL. IN ORDER TO FLOOD, THE BUSHING MUST BE MOUNTED ON THE APPARATUS, THEN EVACUATED TO 5mm VACUUM WHILE THE EQUIPMENT IS BEING FILLED WITH OIL.