

PART NO. 321250

NO. REQ.	ITEM NO.	PART NO.	MATERIAL	DESCRIPTION
1	1	654644	COPPER	BUS-BAR SPADE
1	2	651054	COPPER, C83300	CONNECTOR CAP
1	3	555021	NITRILE (BUNA-N)	CAP GASKET, .13 TK.
1	4	628326	COPPER, C11000	STUD
1	5	231210	PORCELAIN	BUSHING
1	6	557121	NEOPRENE	CUSHION GASKET
1	7	507100	ALUMINUM ALLOY	MOUNTING FLANGE
1	8	558134	NITRILE (BUNA-N)	TANK GASKET
2	9	508282	BRASS	SPRING LD. WASHER
1	10	572800	BRASS	HEX NUT

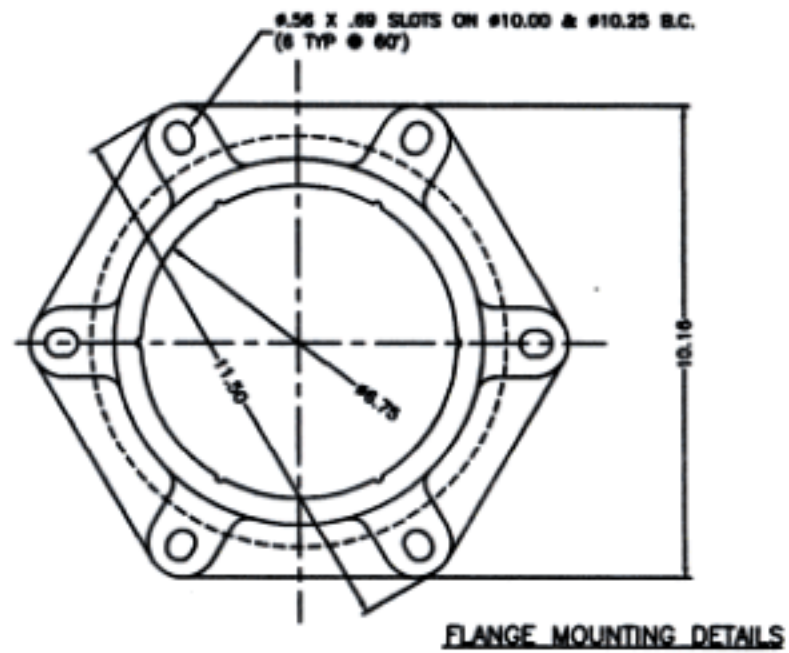
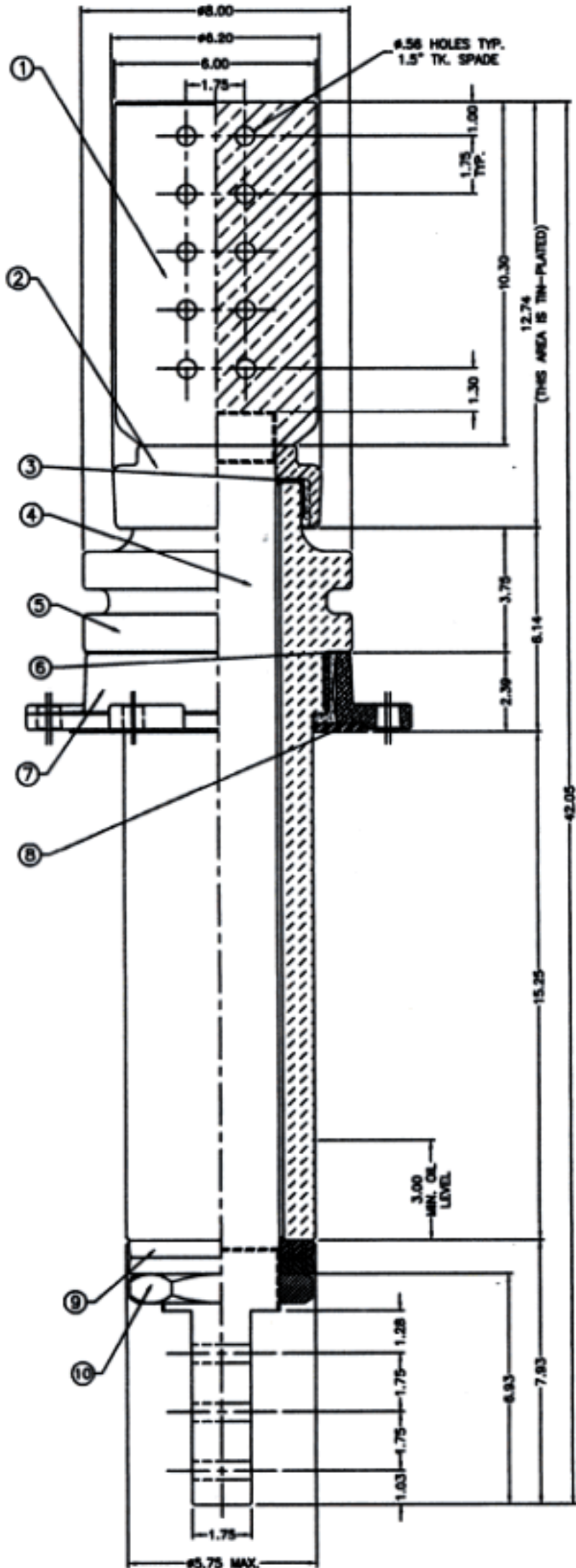

RATINGS: (AIR TO OIL)
 2.5 KV CLASS
 60 KV B.I.L.
 8000 AMPERES

- NOTES:**
- 1) THE COPPER STUD, CONNECTOR CAP AND BUS-BAR ARE JOINED BY BRAZING
 - 2) FLANGE AND CAP ARE JOINED TO PORCELAIN BY EPOXY
 - 3) GRAY GLAZE ALL OVER

